

# 1329 PRINCE RODGERS AVENUE BRIDGEWATER, NEW JERSEY FOR LEASE | RETAIL: 1,760 OFFICE: 1,800 SF up to 7,692 SF

**KYLE GOWOREK**  
kgoworek@jefferyrealty.com  
C: 201.978.1770  
O: 908.668.9600

**SHANE WIERKS**  
swierks@jefferyrealty.com  
C: 908.581.7781  
O: 908.668.9600



**JEFFERY REALTY**  
Retail Specialist

52 Millburn Ave. • Springfield, NJ 07081 • T: 908.668.9600 • F: 908.662.5225 • [www.JefferyRealty.com](http://www.JefferyRealty.com)

All information is from sources deemed reliable and is submitted subject to errors, omissions, change of price, terms, prior sales and withdrawals.



# 1329 PRINCE RODGERS AVENUE

## BRIDGEWATER, NEW JERSEY

**FOR LEASE | RETAIL: 1,760**  
**OFFICE: 1,800 SF up to 7,692 SF**

# SITE INFORMATION

**WHOLE BUILDING CAN BE  
MADE AVAILABLE - 7,692 SF**

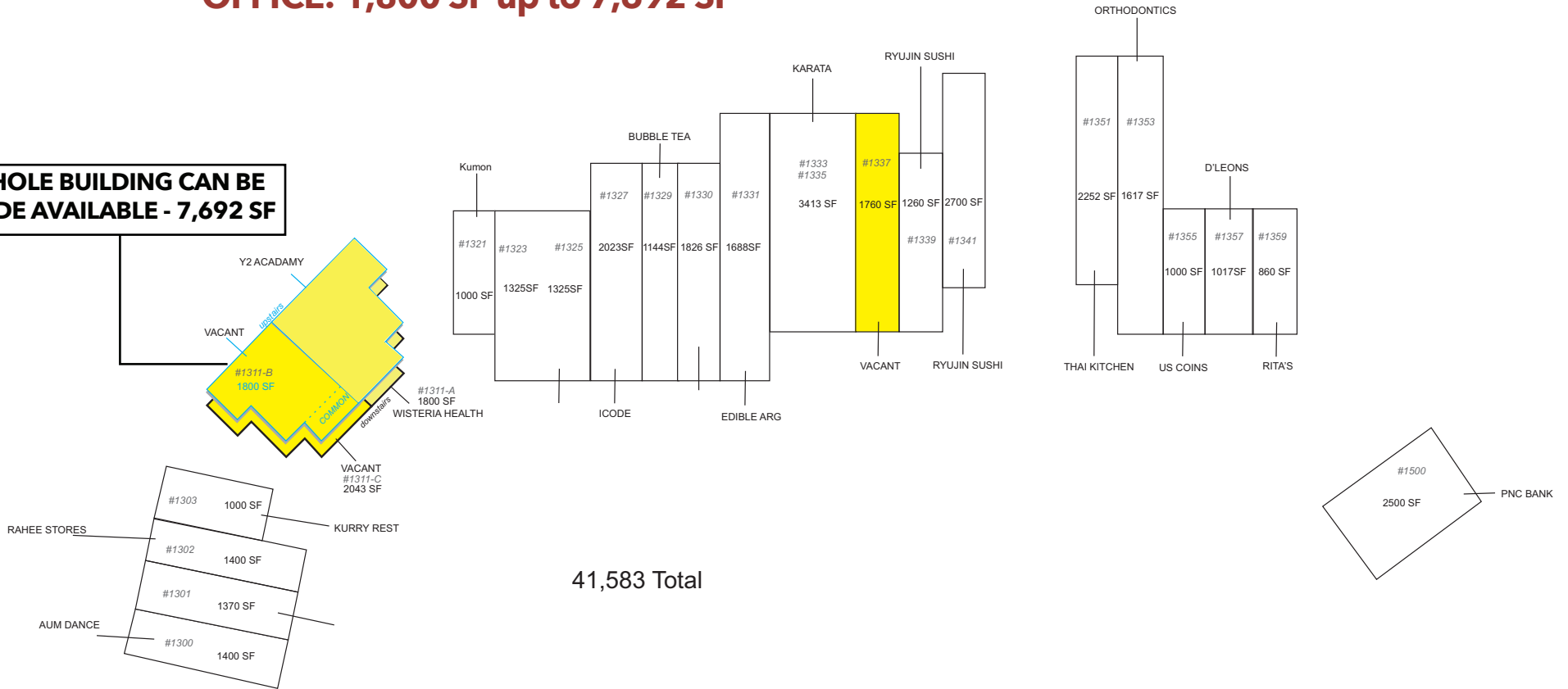

### AVAILABLE

RETAIL: 1,760 &  
OFFICE: 1,800 SF up to 7,692 SF

### RENT

CALL FOR QUOTE

### NNN

\$10.00 psf

### NOTES

- Close proximity to Bridgewater Commons
- New ownership and management
- New facade coming soon

# 1329 PRINCE RODGERS AVENUE

## BRIDGEWATER, NEW JERSEY

**FOR LEASE | RETAIL: 1,760**  
**OFFICE: 1,800 SF up to 7,692 SF**

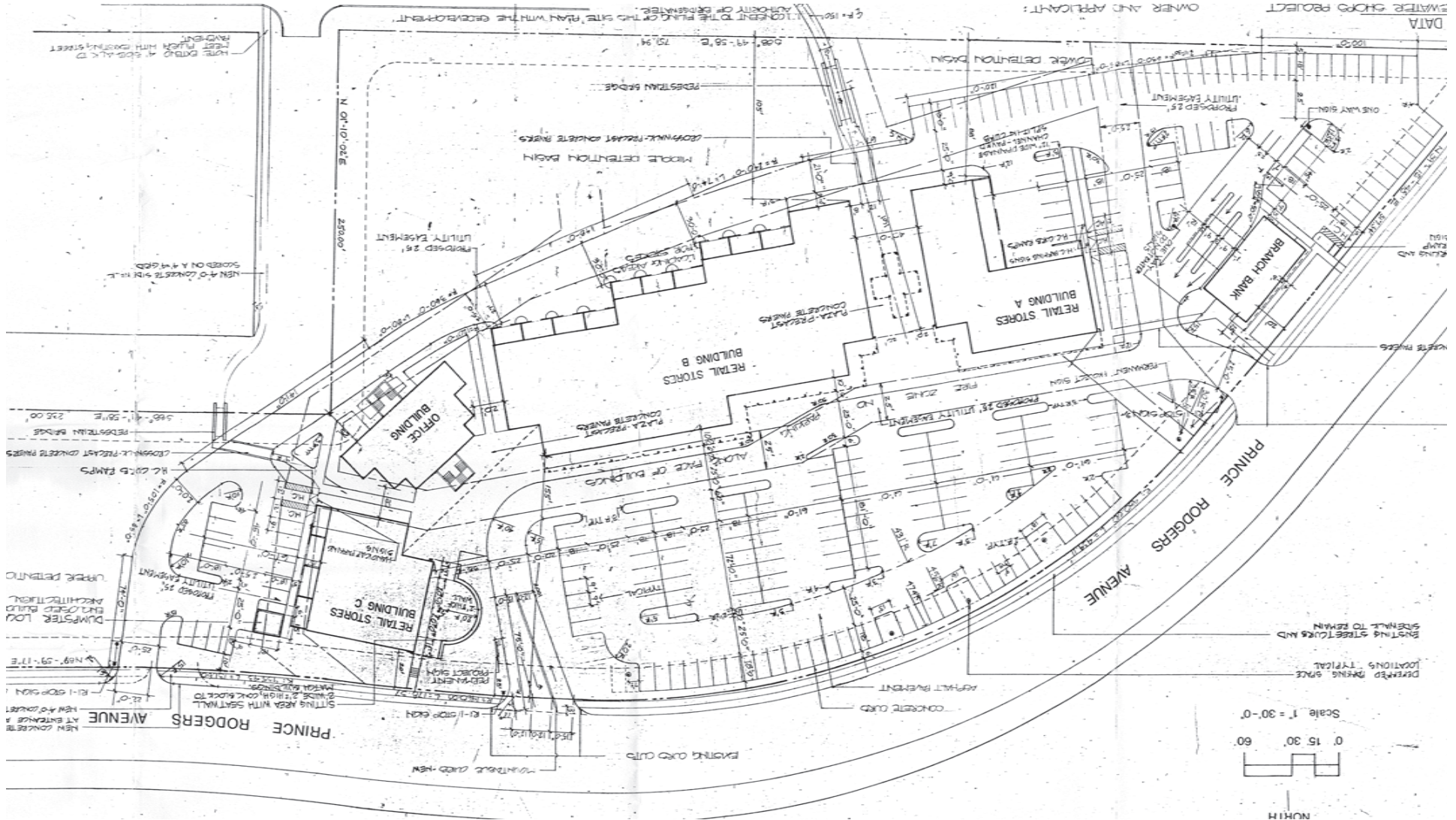

**JEFFERY REALTY**  
Retail Specialist

52 Millburn Ave. • Springfield, NJ 07081 • T: 908.668.9600 • F: 908.662.5225 • [www.JefferyRealty.com](http://www.JefferyRealty.com)

All information is from sources deemed reliable and is submitted subject to errors, omissions, change of price, terms, prior sales and withdrawals.



**1329 PRINCE RODGERS AVENUE**  
**BRIDGEWATER, NEW JERSEY**  
**FOR LEASE | RETAIL: 1,760**  
**OFFICE: 1,800 SF up to 7,692 SF**

 **SITE PHOTOS**



# 1329 PRINCE RODGERS AVENUE

BRIDGEWATER, NEW JERSEY

FOR LEASE | RETAIL: 1,760

OFFICE: 1,800 SF up to 7,692 SF



 DEMOGRAPHICS	1 MILE	3 MILE	5 MILE
TOTAL POPULATION	7,901	59,049	132,917
AVERAGE HHI	\$162,138	\$174,792	\$185,134
HOUSEHOLDS	3,146	21,709	49,696



**JEFFERY REALTY**  
Retail Specialist

52 Millburn Ave. • Springfield, NJ 07081 • T: 908.668.9600 • F: 908.662.5225 • [www.JefferyRealty.com](http://www.JefferyRealty.com)

All information is from sources deemed reliable and is submitted subject to errors, omissions, change of price, terms, prior sales and withdrawals.

