



2920 ROUTE 10

MORRIS PLAINS, NEW JERSEY

PELICAN PLAZA WEST

FOR LEASE **7,310 SF & 7,671 SF**

CIARAN McNELIS
 cmcnelis@jefferyrealty.com
 C: 908.907.7614
 O: 908.668.9600 EXT. 221

SHANE WIERKS
 swierks@jefferyrealty.com
 C: 908.581.7781
 O: 908.668.9600 EXT. 209



JEFFERY REALTY
 Retail Specialist

52 Millburn Ave. • Springfield, NJ 07081 • T: 908.668.9600 • F: 908.668.5225 • www.JefferyRealty.com
 All information is from sources deemed reliable and is submitted subject to errors, omissions, change of price, terms, prior sales and withdrawals.





2920 ROUTE 10 POWDER MILL PLAZA WEST

SITE INFORMATION

CENTER SIZE: 70,000 SF

PARKING: PER CODE

NNN: \$5.41 PSF

AVAILABLE: 7,310 SF - 7,671 SF

FRONTAGE: 692' ON RT. 10

NOTES: • MULTIPLE PYLON LOCATIONS ON

RENT: CALL FOR QUOTE

TRAFFIC: 52,124 VPD RT. 10

ROUTE 10



JEFFERY REALTY
Retail Specialist

52 Millburn Ave. • Springfield, NJ 07081 • T: 908.668.9600 • F: 908.668.5225 • www.JefferyRealty.com

All information is from sources deemed reliable and is submitted subject to errors, omissions, change of price, terms, prior sales and withdrawals.





**7,671 SF
AVAILABLE**

2920 ROUTE 10 POWDER MILL PLAZA WEST

SITE PHOTO



JEFFERY REALTY
Retail Specialist

52 Millburn Ave. • Springfield, NJ 07081 • T: 908.668.9600 • F: 908.668.5225 • www.JefferyRealty.com
All information is from sources deemed reliable and is submitted subject to errors, omissions, change of price, terms, prior sales and withdrawals.



SITE SOURCE
REAL ESTATE NETWORK

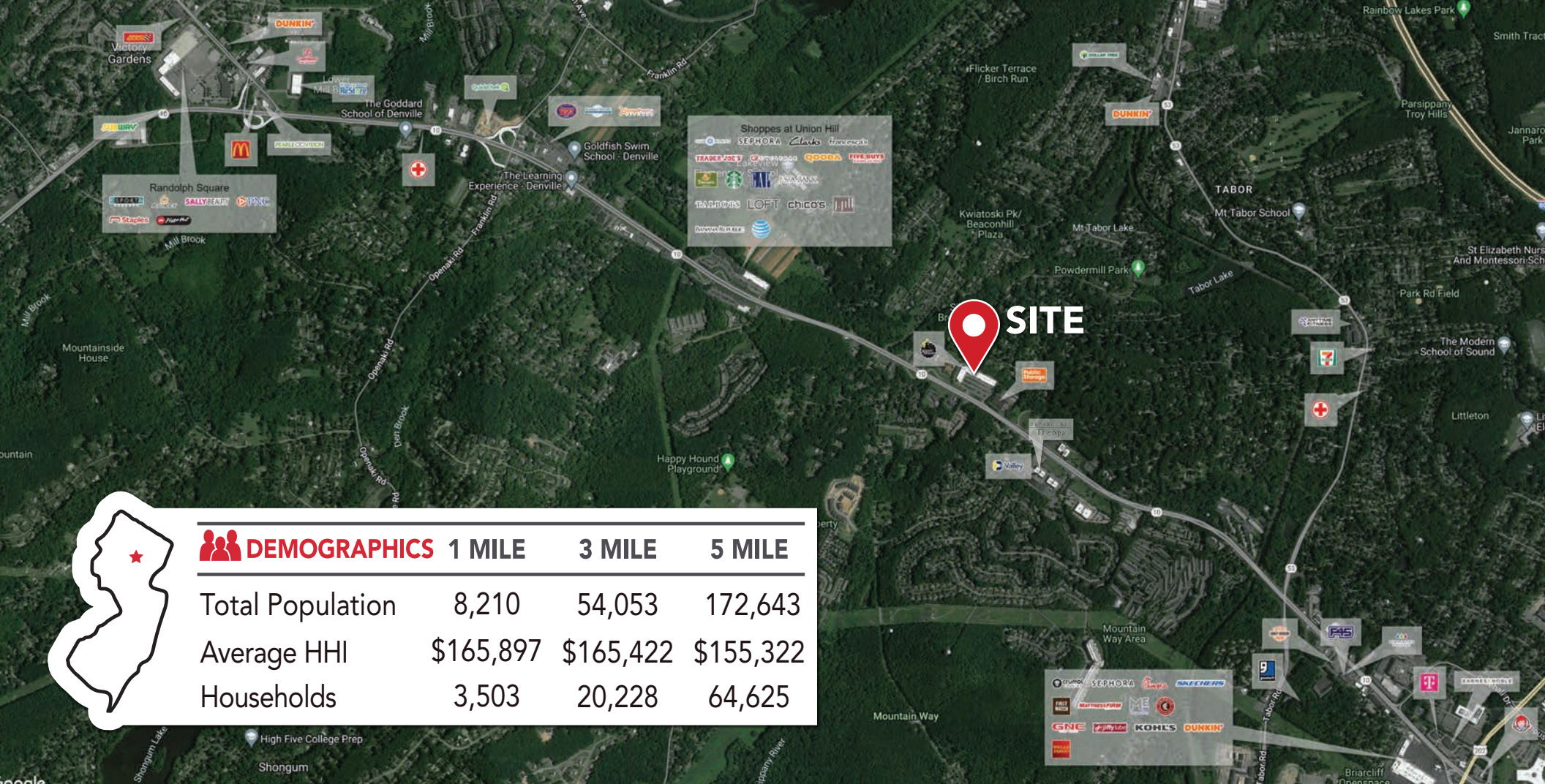

2920 ROUTE 10 POWDER MILL PLAZA WEST

MARKET AERIAL



JEFFERY REALTY
Retail Specialist

52 Millburn Ave. • Springfield, NJ 07081 • T: 908.668.9600 • F: 908.668.5225 • www.JefferyRealty.com

All information is from sources deemed reliable and is submitted subject to errors, omissions, change of price, terms, prior sales and withdrawals.





**7,310 SF
AVAILABLE**

2920 ROUTE 10 POWDER MILL PLAZA WEST

SITE PHOTO

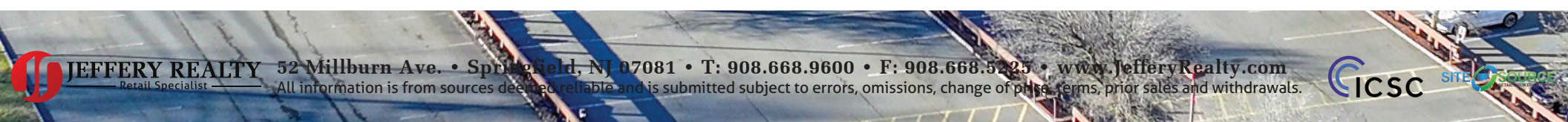

JEFFERY REALTY
Retail Specialist

52 Millburn Ave. • Springfield, NJ 07081 • T: 908.668.9600 • F: 908.668.5225 • www.JefferyRealty.com

All information is from sources deemed reliable and is submitted subject to errors, omissions, change of price, terms, prior sales and withdrawals.



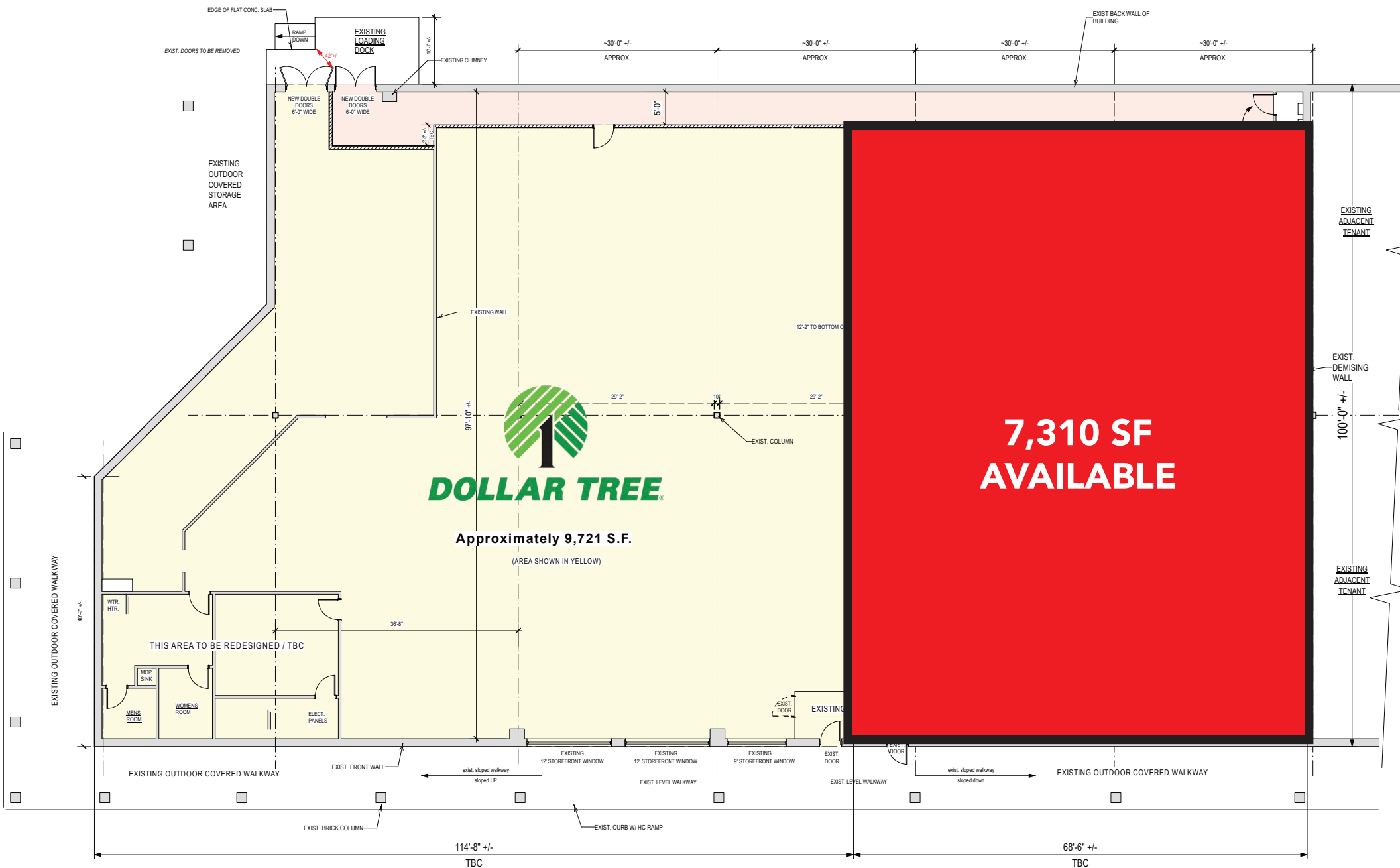

2920 ROUTE 10 POWDER MILL PLAZA WEST

FLOOR PLAN 1



JEFFERY REALTY
Retail Specialist

52 Millburn Ave. • Springfield, NJ 07081 • T: 908.668.9600 • F: 908.668.5225 • www.JefferyRealty.com
All information is from sources deemed reliable and is submitted subject to errors, omissions, change of price, terms, prior sales and withdrawals.

